

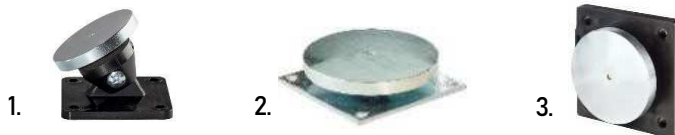

CE
modelli certificati
certified models
UNI EN 1155:2003



1.1



- UTILIZZATO SU PORTE A BATTENTE: OVE NON SIA RICHIESTO IL PULSANTE DI SGANCIO INTEGRATO
- UTILIZZATO SU PORTONI SCORREVOLI: CON CONTROPIASTRA FISSA S02 – SH2 – S05

COSTRUZIONE:

- 50 E 100 Kg: BASE IN ROBUSTO MATERIALE PLASTICO
- 100 Kg: BASE IN ACCIAIO ZINCATO SOLO MODELLO S13
- 150 Kg: BASE IN ACCIAIO ZINCATO

CONNESSIONE ELETTRICA:

- MODELLO S1: SU FILI LIBERI
- MODELLO S13: SU MORSETTO

TENSIONE DI FUNZIONAMENTO STANDARD: 24 Vdc

VARIANTI ED ACCESSORI:

- FORZA DI TENUTA DA 50,100,150 Kg
- TENSIONE DI ALIMENTAZIONE DIVERSA
- LUNGHEZZA FILI DIVERSA (STANDARD L=70mm)

ANCORAGGI:

- S01 CONTROPIASTRA SNODATA (fig. 1)
- S02 – SH2 CONTROPIASTRA FISSA (fig. 2)
- S05 CONTROPIASTRA (fig. 3)

- USED ON SWING DOORS: WHEN INTEGRATED RELEASE BUTTON IS NOT REQUESTED
- USED ON SLIDING DOORS: WITH FIX KEEPER PLATE S02 – SH2 – S05

CONSTRUCTION:

- 50 AND 100 Kg: BASE IN ROBUST PLASTIC MATERIAL
- 100 Kg: GALVANIZED STEEL BASE ONLY FOR S13 MODEL
- 150 Kg: GALVANIZED STEEL BASE

ELECTRICAL CONNECTION:

- S1 MODEL: DIRECTLY ON FREE WIRES
- S13 MODEL: ON THE TERMINAL

STANDARD POWER SUPPLY: 24 Vdc

VARIANTS AND ACCESSORIES:

- HOLDING FORCE 50,100,150 Kg
- DIFFERENT SUPPLY VOLTAGE
- DIFFERENT LENGTH WIRES (STANDARD L=70mm)

KEEPER PLATES:

- S01 ADJUSTABLE KEEPER PLATE (fig. 1)
- S02 – SH2 FIXED KEEPER PLATE (fig. 2)
- S05 KEEPER PLATE (fig. 3)



Tipo / Type	A	B	C	D	E	F	G
S1x06x	68	68	30	50	52	52	Ø 6
S1x11x	68	68	40	60	52	52	Ø 6
S1x16x	75	75	40	70	60	60	Ø 6

Dimensioni in mm / Dimensions in mm
X= valore variabile / variable value

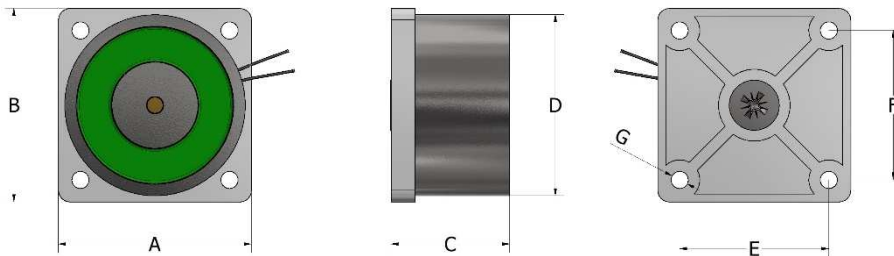

Modello / Model	Contropiastra inclusa / Keeper plate included	Forza / Holding force Kg	Tensione / Power supply Vdc	Assorbimento / Rated current mA	Circuito di protezione / Protection circuit	Morsetto / Terminal
S10060-01	S01060	50	24	60	No	No
S10061-01	S01060	50	12	120	No	No
S10062-01	S01060	50	48	30	No	No
S13060-02	S02060	50	24	60	No	Si / Yes
S13061-02	S02060	50	12	120	No	Si / Yes
S13062-02	S02060	50	48	30	No	Si / Yes
S10110-01	S01110	100	24	100	No	No
S10111-01	S01110	100	12	200	No	No
S10112-01	S01110	100	48	50	No	No
S13110-05	S05110	100	24	100	No	Si / Yes
S13111-05	S05110	100	12	200	No	Si / Yes
S13112-05	S05110	100	48	50	No	Si / Yes
S10160-02	S02160	150	24	100	No	No
S10161-02	S02160	150	12	200	No	No
S10162-02	S01160	150	48	50	No	No
S10160-H2	SH2160	150	24	100	No	No
S10161-H2	SH2160	150	12	200	No	No
S10162-H2	SH1160	150	48	50	No	No

Per le dimensioni delle contropiastre si veda pag. 1.16 / Keeper plate dimensions available on page 1.16